

Early Hearing Detection & Intervention Conference

EHDI 2008

NEW ORLEANS



Program Book

February 25-26, 2008

Astor Crowne Plaza • New Orleans, Louisiana



THE EHDI CONFERENCE SERVICE PROJECT

Wednesday, February 27, 2008

In the EHDI community, we share the desire to make a lasting, positive impact on the lives of others. While participating in the EHDI Conference, you'll see how the French Quarter and other parts of New Orleans are well along the road to recovery. However, not far away, many neighborhoods are still in distress and families are without homes. Now you have an opportunity to work side-by-side with your EHDI colleagues to rebuild this great city and leave someone's future a little brighter than you found it.

We welcome your participation in the voluntary service project with the New Orleans Area Habitat for Humanity. Habitat is dedicated to the ideal that all people deserve a simple, decent, healthy place to live on terms they can afford to pay. Working in partnership with individual volunteers, faith communities, organizations and the new homeowner families, Habitat is building houses and building hope around the world.

Thank you to all who will take part in the service project!

TABLE OF CONTENTS

| | |
|---------------------------|----|
| Agenda At A Glance | 2 |
| General Information | 4 |
| CME Information | 5 |
| CEU Information | 7 |
| Full Agenda | 8 |
| Exhibitors | 18 |
| Poster Session | 19 |
| Presenter Index | 21 |
| Hotel Layout | 24 |



AGENDA AT A GLANCE

Sunday, February 24, 2008

| | | |
|-------------------|--------------------------------|-----------------|
| 6:00 pm – 8:00 pm | Registration Open | Grand Foyer |
| 6:00 pm – 8:00 pm | Speaker Ready Room Open | Royal Boardroom |
| 7:00 pm – 9:00 pm | Film: <i>Through Deaf Eyes</i> | Toulouse B |

Monday, February 25, 2008

| | | |
|---------------------|--------------------------------|---|
| 7:00 am – 3:30 pm | Registration Open | Grand Foyer |
| 7:30 am – 8:15 am | Continental Breakfast | Astor Ballroom & Grand Foyer |
| 7:30 am – 5:30 pm | Speaker Ready Room Open | Royal Boardroom |
| 7:30 am – 7:30 pm | Exhibits Open | Astor Ballroom |
| 8:15 am – 9:15 am | Opening Plenary | Grand Ballroom |
| 9:35 am – 10:35 am | State Team Meeting | See locations in State Meeting tab |
| 10:55 am – 11:55 am | Topical Session 1 | |
| 12:15 pm – 1:00 pm | Poster Session | Astor Gallery & Grand Gallery |
| 12:45 pm – 2:00 pm | Lunch (Box Lunch Provided) | Astor Ballroom 1 & 3 |
| 2:00 pm – 3:00 pm | Topical Session 2 | |
| 3:20 pm – 3:50 pm | Topical Session 3 | |
| 4:10 pm – 5:10 pm | Plenary II | Grand Ballroom |
| 5:30 pm | Brass Band and Second Line | Meet in Grand Foyer |
| 5:45 pm – 7:30 pm | Reception | Astor Ballroom, Astor Gallery, Canal Balcony, & Bourbon Balcony A |
| 7:00 pm – 9:00 pm | Film: <i>Through Deaf Eyes</i> | Toulouse B |

AGENDA AT A GLANCE Cont'd

Tuesday, February 26, 2008

| | | |
|---------------------|------------------------------------|------------------------------------|
| 7:15 am – 8:00 am | Continental Breakfast | Astor Ballroom & Grand Foyer |
| 7:15 am – 2:30 pm | Exhibits Open | Astor Ballroom 1 & 3 |
| 7:30 am – 12:00 pm | Registration Open | Grand Foyer |
| 8:00 am – 9:00 am | Plenary III | Grand Ballroom |
| 9:20 am – 10:20 am | Topical Session 4 | |
| 10:40 am – 11:40 am | Topical Session 5 | |
| 11:40 am – 1:00 pm | Lunch (On Your Own) | |
| 11:45 am – 1:45 pm | AAP Chapter Champion Working Lunch | St. Charles B |
| 1:00 pm – 2:00 pm | Topical Session 6 | |
| 2:15 pm – 2:45 pm | Topical Session 7 | |
| 3:00 pm – 3:45 pm | State Team Meeting | See locations in State Meeting tab |
| 4:00 pm – 4:45 pm | Closing Plenary | Grand Ballroom |



AGENDA AT A GLANCE

2008 NATIONAL EARLY HEARING DETECTION AND INTERVENTION CONFERENCE

February 25-26, 2008
Astor Crowne Plaza, New Orleans, Louisiana

The 2008 national EHDI conference is cosponsored by the American Academy of Pediatrics, the Centers for Disease Control and Prevention, the Maternal and Child Health Bureau and the National Center on Hearing Assessment and Management.

GENERAL CONFERENCE INFORMATION

You should attend the 2008 National Early Hearing Detection and Intervention conference if you are interested in receiving:

- High quality education and an opportunity to interact one-on-one with the faculty and other experts in the field of early hearing detection and intervention.
- Current and practical information to take back to your practice or other work setting and use immediately.
- Data on recent research in early hearing detection and intervention that can be translated into practice.
- “Hot topics” covering the latest in early hearing detection and intervention.
- Case-based sessions, roundtable discussions and instructional skill-building workshops offering expert opinion and experiences about situations you encounter related to early hearing detection and intervention in practice and/or other work settings.



The conference combines lectures, panel discussions, and question-and-answer sessions to allow you the opportunity to interact with the faculty in solving the problems you encounter related to EHDI in daily practice and in policy and programmatic activities.

LEARNING OBJECTIVES

At the conclusion of this activity the participant will be able to:

- Identify and promote knowledge and awareness of successful strategies for implementing comprehensive state-based Early Hearing Detection and Intervention (EHDI) programs that include screening, audiologic and diagnostic evaluation, early intervention, medical home, reporting, tracking, surveillance, lost to follow up issues, data integration, and other related surveillance components.
- Interpret and describe current research and research methods related to EHDI.
- Examine cultural competence of providers and assess their ability to work with children who have a hearing loss, their families, and communities.
- Discuss the importance of enhancing and creating new and ongoing working relationships among federal agencies, non-profit organizations, state health departments and educational agencies, advocacy groups, families, and professionals.

CME ACCREDITATION INFORMATION

ACCREDITATION INFORMATION

Continuing Medical Education (CME)

The American Academy of Pediatrics is accredited by the Accreditation Council for Continuing Medical Education to provide continuing medical education for physicians.

The AAP designates this educational activity for a maximum of 5.75 *AMA PRA Category 1 Credit(s)*[™]. Physicians should only claim credit commensurate with the extent of their participation in the activity.

This activity is acceptable for up to 5.75 AAP credits. These credits can be applied toward the AAP CME/CPD Award available to Fellows and Candidate Fellows of the American Academy of Pediatrics.

The American Academy of Physician Assistants accepts *AMA PRA Category 1 Credit(s)*[™] from organizations accredited by the ACCME.

This program is approved for 5.75 NAPNAP contact hours of which 0 contain pharmacology (Rx) content per the National Association of Pediatric Nurse Practitioners Continuing Education Guidelines.

NOTE: Continuing Medical Education credit is only offered for the conference plenary sessions and the special AAP session to be held on Tuesday, February 26 at 11:45 am.

American Academy
of Pediatrics



DEDICATED TO THE HEALTH OF ALL CHILDREN[™]



RECORDING CME CREDIT

To record your *AMA PRA Category 1 Credit(s)*[™] in the AAP transcript files, physicians need to directly access the transcript system on *PediaLink*[®] at www.pedialink.org, within one year of the CME activity. AAP members and *PediaLink*[®] subscribers may access their transcripts free of charge; non-members may choose to access their transcripts for a fee. The subscription fees are posted at www.pedialink.org.

AAP Members, *PediaLink*[®] subscribers or non-members who want the AAP to record their credit for them must mail a complete copy of your certificate of attendance with your name, the number of credits you are claiming, and a check for \$25.00 payable to the AAP. Your credits will be recorded and a transcript sent to you.

AAP Members and *PediaLink*[®] subscribers please make sure to include your AAP ID number. Send to:

American Academy of Pediatrics

Attn: Transcript Coordinator
141 Northwest Point Blvd.
Elk Grove Village, IL 60007-1098

AAP CME Transcripts Are Now As Easy as 1 · 2 · 3!

1) Activate your *PediaLink*[™] account.

- Go to www.pedialink.org
- Click **Activate Your Account** beneath the Login button.
- Enter your AAP ID#, last name, and date of birth.
- Click **Submit**
- Verify your information and create your password.
- Click **Next**.
- Complete the background information (2 screens).
- Click **Next**.

2) Claim Credit for an AAP Live CME event.

- Go to www.pedialink.org
Enter your AAP ID and password.
- Click **Login**
- Find the heading **My Transcript**
- Click **Claim CME Credit**
- Select the appropriate activity and enter the number of credit hours you are claiming.
- Click **Claim Hours**

3) Print your transcript 24/7 FOR FREE!

- Go to www.pedialink.org, enter your AAP ID and password, click **“log in”**
- Click on **View/Print Transcript** on the left hand side of the screen
- Click on the **Print Icon** on the right hand side of the screen
- Select a year for the date range, click **“Print Preview”**
- Click on the **Printer Icon** in the *upper right hand corner* of the screen.

CONTINUING EDUCATION UNITS

CONTINUING EDUCATION UNITS (CEUs)

American Academy of Audiology

Participants seeking American Academy of Audiology (AAA) CEUs will find the AAA Registration Form under the CEU Tab in their conference packets. It is necessary to complete this form and send it to the address noted on the form to receive American Academy of Audiology CEUs.

Participants seeking CEU credits from the AAA must complete evaluation forms for each of the sessions that they attend. The session evaluation forms will be available in each of the breakout session rooms, and will be collected after each session. Each form has a box to check and place to enter a name if AAA credit is being requested. These forms will be used to determine the number of CEUs the participant earns.

The National Center on Hearing Assessment and Management has submitted an application to the American Academy of Audiology to offer Academy CEUs for the 2008 EHDI conference. The program may be worth a maximum of 1.2 CEUs, if approved. Instructions and the required paperwork will be available in the CEU Tab of your conference packet. Academy approval of this continuing education activity does not imply endorsement of course content, specific products, or clinical procedures.

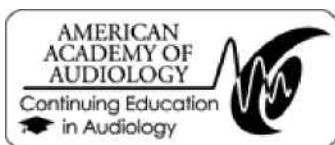

American Speech-Language-Hearing Association

Participants seeking American Speech-Language-Hearing Association (ASHA) CEUs will find the ASHA CEU Participant Form in their registration packets. It is necessary to complete this form and return it to the conference registration table at the end of the conference on February 26.

Variable credit will be awarded depending upon the activities attended. Please see your registration packet for the breakdown of contact hours. When filling out your Participant Form, please write the total number of contact hours you earned in the upper right-hand corner of the form. This number will be converted to CEUs for you.

Utah State University has submitted an application to the American Speech-Language-Hearing Association to offer ASHA CEUs for the 2008 EHDI Conference. Utah State University is approved by the Continuing Education Board of the American-Speech-Language-Hearing Association (ASHA) to provide continuing education activities in speech-language pathology and audiology. This program is offered for up to 1.2 CEUs (intermediate level; related area). ASHA CE Provider approval does not imply endorsement of course content, specific products, or clinical procedures.



AGENDA

Sunday, February 24, 2008

- 6:00 pm – 8:00 pm Registration Open
Grand Foyer
- 6:00 pm – 8:00 pm Speaker Ready
Room Open
Royal Boardroom
- 7:00 pm – 9:00 pm Film: *Through Deaf Eyes*
Toulouse B

Monday, February 25, 2008

- 7:00 am – 3:30 pm Registration Open
Grand Foyer
- 7:30 am – 8:15 am Continental Breakfast
Astor Ballroom & Grand Foyer
- 7:30 am – 7:30 pm Exhibits Open
Astor Ballroom
- 8:15 am – 9:15 am Opening Plenary
Grand Ballroom
- Through Deaf Eyes Panel**
(Continuing Medical Education Provided)
Presented by Harry Lang, Irene W. Leigh, Carolyn McCaskill, and James Tucker
Moderated by Barbara Raimondo and Karl White
- 9:35 am – 10:35 am State Team Meeting
See room assignments in State Meeting tab

Topical Session 1

10:55 am – 11:55 am
Monday, February 25, 2008

Room – Astor II
OZ Systems: Creating Links for Newborn Screening Programs
Presented by Lura Daussat
Time – 60 minutes

Room – St. Charles A
Public Policy, Citizen Advocates, and Coalition Building: Your New BFF
Presented by Mary Hartnett, Toni Fairbanks, Nicole Brown
Time – 60 minutes

Room – St. Charles B
Screening for Developmental Delays in Children who are Deaf/HOH
Presented by Susan Wiley
Time – 30 minutes

Prevalence of ADHD and LD in Children with Hearing Loss
Presented by Krista R. Biernath
Time – 30 minutes

Room – Grand Ballroom A
Parents' Views of the Impact of Early Diagnosis on Child Development
Presented by Alys Young
Time – 30 minutes

From the Parent's Perspective: What We Need to Feel Supported
Presented by Nannette Nicholson, Patti Martin, Jan Stroud
Time – 30 minutes

Room – Grand Ballroom C
Newborn Hearing Screening Training Module
Presented by Randi Winston
Time – 60 minutes

AGENDA Cont'd

Topical Session I – Continued

Room – Grand Ballroom D

Language Outcomes for Young Children with Hearing Loss

Presented by *Joni Alberg, Christene Tashjian, and Kathryn Wilson*

Time – 60 minutes

Room – Toulouse A

A Learning Collaborative Approach to EHDI System Improvement

Presented by *Shirley Russ, Doris Hanna, Hallie Morrow, Janet DesGeorges*

Time – 60 minutes

Room – Toulouse B

Business Case for Integrating EHDI and Other Info Systems

Presented by *Karen Torghelle, Alan Hinman*

Time – 60 minutes

Room – Iberville

Free Money and Where to Find It: Offering Families Financial Support

Presented by *Genevieve DelRosario*

Time – 60 minutes

Room – Bienville

Implementing EI Services Using the SKI-HI Model within a South African Context

Presented by *Claudine Storbeck, Paula Pittman*

Time – 60 minutes

Room – Bourbon

Monitoring Risk Factors for Late Onset Hearing Loss

Presented by *Susan J. Norton, Richard C. Folsom*

Time – 60 minutes

Room – Burgundy

Cochlear Implants: The Role of the EI Specialist

Presented by *Carissa Moeggenberg*

Time – 60 minutes

Poster Session

12:15 pm – 1:00 pm

Monday, February 25, 2008

ASTOR GALLERY

1000 Hz Tympanometry for the Older End of the EHDI Spectrum

Presenter: *Wendy D. Hanks*

A New Frontier: Current EHDI Activities in Latin America

Presenters: *Barbara Gerner De Garcia, Claudia Gaffney, Susan Chacon, Marcus Gaffney*

Assessing Needs of Diverse Populations in the EHDI System

Presenters: *John Ribera, Claudia Gaffney, Susan Chacon*

Beyond UNHS: Outcomes from Comprehensive Periodic Screening

Presenters: *William Eiserman, Terry Foust*

Data Compliance Scorecard

Presenters: *Christy Taylor, Sondi Aponte*

Deaf Adults' Perspectives on EI for Deaf and Hard of Hearing Children

Presenter: *Kayla Buswell*

Don't Leave Home Without It: Assessment Guidelines

Presenters: *Mary Ann Lyon, Kylie Sharp*

Effects of Health Professionals' Advice on Parental Decision-Making

Presenter: *Lori A. Day*

Evidence-Based Medical Algorithm for Infants with SNHL

Presenters: *Mary Meier, Yaoli Li*

Families Resistant to Hearing Aid Use for Their Children

Presenter: *Jana L. Zeigberman*

AGENDA Cont'd

Poster Session – Continued

Findings from an Evaluation of Loss to Follow-Up in Five State EHDI Programs
Presenter: *Lucia Rojas Smith*

Hearing Loss and “Very Early” EI: Emerging Language & Behavior at Two
Presenter: *Betty Vohr*

Integrating EHDI & Metabolic Screens: Break Down of Information Silos
Presenters: *Thalia Wood, John Cartwright*

GRAND GALLERY

Issues in Unilateral and Bilateral Minimal Hearing Loss - Part 1
Presenters: *Carol Knightly, Sarah McKay, Judith Gravel*

Issues in Unilateral and Bilateral Minimal Hearing Loss - Part 2
Presenters: *Judith Gravel, Estelle Goldsmith, Sarah McKay, Carol Knightly*

Issues in Unilateral and Bilateral Minimal Hearing Loss - Part 3
Presenters: *Sarah McKay, Carol Knightly, Judith Gravel*

Knowledge Needs on Cochlear Implantation
Presenter: *Donna L. Sorkin*

Lost to Follow-up: Proving a Small Change Can Make a Difference
Presenter: *Lori Mibus*

Multidisciplinary Care of Childhood Hearing Loss: CATIPIHLER
Presenter: *Eileen Rall*

New 2006 CDC EHDI Data: What Progress Has Been Made?
Presenters: *Marcus Gaffney, Claudia Gaffney*

One, Two, Three - Red Light! Data Management and Tracking... At a Glance
Presenter: *Sallie C. McCall*

Partnering with Families
Presenter: *Maryann C. Swann*

The New Jersey Pediatric Hearing Health Care Directory
Presenter: *Karyn A. Dynak*

The Process of Grief in Mexican Parents of Hearing Loss Children
Presenter: *Sandra Veronica Perez-Izquierdo*

TN-CHP: Web Model to Improve Follow-up of Hearing Screening
Presenter: *Carmen B. Lozzio*

Washington State EHDDI Summits: Creating Partnerships
Presenters: *Amber Roche, Karin Neidt*

What's So Special About Dads?
Presenters: *Cory MacIver, Holly F. Pedersen*

AGENDA Cont'd

Topical Session 2
2:00 pm – 3:00 pm
Monday, February 25, 2008

Room – Astor II

Remote CART: A Higher Level of Service for a Higher Level of Education (EXHIBITOR)

Presented by *Joe Delulio*

Room – St. Charles A

EHDI Experts' New Role in Early Childhood Screening

Presented by *William Eiserman, Terry Foust*
Time – 30 minutes

Hearing Screening During Well-Child Visits: A Pilot Evaluation

Presented by *Terry Foust, William Eiserman*
Time – 30 minutes

Room – St. Charles B

Family Support: Take It to the Next Level!

Presented by *Patti Martin, Leeanne Seaver, Joni Alberg, Galya Hutsell*
Time – 60 minutes

Room – Grand Ballroom A

Outcomes for Children with HL: Effects of Age of ID, Sign Support, and Auditory Prosthesis

Presented by *Susan Nittrouer*
Time – 60 minutes

Room – Grand Ballroom C

Professional Development for Early Intervention Providers

Presented by *Marilyn Sass-Lehrer, Beth Benedict*
Time – 30 minutes

Models of Professional Development for Early Interventionists

Presented by *Laurie Cochenour, Mary Ellen Nevins*
Time – 30 minutes

Room – Grand Ballroom D

Loss to Follow-up Rate of 10% – You Can Get There Too!

Presented by *Hallie Morrow, Jennifer Sherwood, Lisa Satterfield*
Time – 60 minutes

Room – Toulouse A

Developing Community Partnerships for Cultural Diversity Training

Presented by *Jill Ellis*
Time – 60 minutes

Room – Toulouse B

It Takes a Village: Serving Children with Hearing Loss and Their Families

Presented by *Todd Houston, Ruth Mathers, Karen Munoz*
Time – 60 minutes

Room – Iberville

Over the River and Through the Woods: Serving Rural Families

Presented by *Jennie Germano, Nanette Thompson, Dinah Beams*
Time – 30 minutes

Reaching Families in Rural Areas Through Video-Conferencing

Presented by *Jan North, Melissa McCarthy*
Time – 30 minutes

Room – Bienville

Cued Speech: Visual Access to Spoken Language

Presented by *Barbara LeBlanc, Denise Taylor, Penny Hakim*
Time – 30 minutes

American Sign Language and Cued Languages: Partners in Bilingualism

Presented by *Allison Kaftan, Polly Earl*
Time – 30 minutes

AGENDA Cont'd

Topical Session 2 – Continued

Room - Bourbon

ASHA Policy Documents: Providing Guidance for Improving ELDI Outcomes

Presented by *Allan O. Diefendorf, Judith S. Gravel, Anne Marie Tharpe*
Time – 60 minutes

Room - Burgundy

Advocacy for Children Using the Individuals with Disabilities Act

Presented by *Barbara Raimondo*
Time – 60 minutes

Topical Session 3

3:20 pm – 3:50 pm

Monday, February 25, 2008

Room – St. Charles A

Comparison of Intervention Settings for Infants and Toddlers with Hearing Loss

Presented by *Anne Marie Tharpe*
Time – 30 minutes

Room – St. Charles B

HEAR Chart – Hierarchy of Early Auditory Responses

Presented by *Diana Lee, Elizabeth Hopkins*
Time – 30 minutes

Room – Grand Ballroom A

Effectiveness of Ohio’s Early Intervention on Language Outcomes

Presented by *Jareen Meizen-Derr, Susan Wiley, Constance Block, Daniel Choo*
Time – 30 minutes

Room – Grand Ballroom C

Factors Associated with Newborn Hearing Screening Follow-up

Presented by *Vickie Thomson*
Time – 30 minutes

Room – Grand Ballroom D

Auditory Neuropathy / Dys-synchrony

Presented by *Jan Stroud, Patti Martin, Nannette Nicholson*
Time – 30 minutes

Room – Toulouse A

Making I.T. Work for You

Presented by *Nick Waddell*
Time – 30 minutes

Room – Toulouse B

KIDSNET and RITRACK... Partnering for Audiological Reporting

Presented by *Mary Catherine Hess, Michael Berry*
Time – 30 minutes

Room - Iberville

Signing with Babies – Hearing...Deaf...Does it Matter?

Presented by *Cheri Dowling*
Time – 30 minutes

Room - Bienville

Expanding Skills of Providers and Culturally Diverse Families

Presented by *Jill Ellis*
Time – 30 minutes

Room – Bourbon

“Hey, What About Us?” - Supporting Families of Young Children Who are Hard of Hearing

Presented by *Janet DesGeorges, Melissa Wagner*
Time – 30 minutes

Room – Burgundy

Opening Doors: Collaborating to Develop Family Friendly Resources

Presented by *Eric S. Cahill, Fran Hardin, Cathy Howle, Wendy Keown*
Time – 30 minutes

AGENDA Cont'd

4:10 pm – 5:10 pm Plenary II
Grand Ballroom

**Cortical Development and Reorganization
in Auditory Deprivation**

(Continuing Medical Education Provided)

Presented by Anu Sharma

Moderated by Susan Wiley

5:10 pm **Presentation of the
Antonia Maxon Award
of Excellence**

5:30 pm **Brass Band and
Second Line
beginning in
Grand Gallery**

Come to the Grand Gallery where a Brass Band, complete with a Grand Marshall, will lead us in a second line parade to the Exhibit Hall to open the reception in New Orleans style! You won't want to miss this New Orleans tradition!

5:45 pm – 7:30 pm Reception
**Astor Ballroom,
Astor Gallery, Canal
Balcony, Bourbon
Balcony A**

ASL for Everybody: Are you curious about American Sign Language? Want to practice your skills? Pick up a few more? Then gather at Canal Street Balcony during the reception, where experienced signers and facilitators will be "on hand" to encourage you in your efforts! Be prepared to socialize, ask any questions you have, and most of all, to have fun! Don't miss this informal - and informative - gathering!

7:00 pm – 8:00 pm Film: *Through Deaf Eyes*
Toulouse B

Tuesday, February 26, 2008

7:15 am – 8:00 am Continental Breakfast
**Astor Ballroom &
Grand Foyer**

7:15 am – 2:30 pm Exhibits Open
Astor Ballroom 1 & 3

7:30 am – 12:00 pm Registration Open
Grand Foyer

8:00 am – 9:00 am Plenary III
Grand Ballroom

Parents & Professionals Unplugged Panel

(Continuing Medical Education Provided)

Presented by Beth Benedict, JoDee Crace,

Janet DesGeorges, Susan Elliott, Julia Hecht,

Michelle King, Lisa Kovacs, Curt Leitz,

Ruth Mathers, Djenne Morris, Stephanie

Olson, Kylie Sharp, Rachel St. John, and

Cami Wright

Moderated by John Eichwald and

Leeanne Seaver

AGENDA Cont'd

Topical Session 4
9:20 am – 10:20 am
Tuesday, February 26, 2008

Room – Astor II

New Counseling Tool for Professionals and Parents (EXHIBITOR)

Presented by *Nicole Robbins*

Room – St. Charles A

Doing What it Takes: Advancing Outcomes for Children with Hearing Loss

Presented by *Teresa H. Caraway, Tamara H. Elder*

Time – 60 minutes

Room – St. Charles B

Decision-making Processes of EHDl Families

Presented by *Marilyn Sass-Lehrer, Sarah Wainscott, Carol Croyle*

Time – 30 minutes

Tough Choices: Parental Perspectives on Decision Making

Presented by *Nannette Nicholson, Alan Vanbiervliet, Meghan Powell, Jan Stroud*

Time – 30 minutes

Room – Grand Ballroom A

Auditory Access for Infants Utilizing PFM Technology

Presented by *Johnnie Sexton*

Time – 60 minutes

Room – Grand Ballroom C

Working Together at the EHDl Program

Presented by *Gayla Hutsell, Bob Bowman, Kristi Zonno, Winnie Chung, Richard Harward, Kurt Randall*

Time – 60 minutes

Room – Grand Ballroom D

Parents to Professionals: What We REALLY Need You to Know

Presented by *Amanda Kaahanui*

Time – 30 minutes

“Sweeten the Pot” - Why EHDl Programs and Service Providers Should Have Parents as Equal Partners on Their Teams

Presented by *Kylie Sharp*

Time – 30 minutes

Room – Toulouse A

Tackling Transition: Resources and Strategies

Presented by *Marcia Kolvitz*

Time – 60 minutes

Room – Toulouse B

Quality Assurance - What Happens to Your Babies?

Presented by *Jennifer Sherwood, Hallie Morrow, Lisa Satterfield*

Time – 60 minutes

Room – Iberville

Civil Rights to Effective Communication

Presented by *Barbara Raimondo*

Time – 60 minutes

Room – Bienville

Long-Term Consequences of Language and Educational Options

Presented by *Gina Oliva, Tami Hossler, Erica Hossler*

Time – 60 minutes

Room – Bourbon

Creative Strategies for Serving Non-English Speaking Families

Presented by *Jennie Germano, Dinah Beams*

Time – 60 minutes

Room - Burgundy

Intervention for Children with Vision Loss and Cochlear Implants

Presented by *Kathleen Stremel*

Time – 60 minutes

AGENDA Cont'd

Topical Session 5
10:40 am – 11:40 am
Tuesday, February 26, 2008

Room – Astor Ballroom 2

Automated ABR Screening in the NICU with Zero Re-tests (EXHIBITOR)

Presented by *Yuri Sokolov*

Time – 30 minutes

Non-sedated ABR Evaluation (EXHIBITOR)

Presented by *Yuri Sokolov*

Time – 30 minutes

Room – St. Charles A

EHDI State Model Bill Phase II Campaign

Presented by *James Potter, Anne Oyler, Rend Al-Mondhiry*

Time – 60 minutes

Room – St. Charles B

Focusing on the “I” in EHDI

Presented by *Marilyn Sass-Lehrer, Arlene Stredler Brown, Mary Pat Moeller*

Time – 60 minutes

Room – Grand Ballroom A

Bridge to Preschool: Ensuring a Successful Transition

Presented by *Janet DesGeorges, Dinah Beams*

Time – 60 minutes

Room – Grand Ballroom C

Hands & Voices’ Guide By Your Side: A Replicable Family Support Program

Presented by *Leeanne Seaver, Stephanie Olson, Elizabeth Seeliger, Candace Lindow Davies*

Time – 60 minutes

Room – Grand Ballroom D

Model Program for Periodic Medical Home Childhood Hearing Screening

Presented by *Christine Gilmore Eubanks, Parul Bhatia*

Time – 60 minutes

Room – Toulouse A

Indiana’s EHDI Alert Response System (EARS)

Presented by *Bob Bowman, Gayla Hutsell*

Time – 60 minutes

Room – Toulouse B

Finding the Lost EHDI Babies – Utilizing Partnerships

Presented by *Chris Watkins*

Time – 60 minutes

Room – Iberville

What is Audism? What Professionals Need to Know

Presented by *Benjamin Bahan, Beth Benedict, Barbara Raimondo*

Time – 60 minutes

Room – Bienville

Addressing the Shortage of Qualified Pediatric Audiologists

Presented by *Les R. Schmeltz*

Time – 60 minutes

Room – Bourbon

Personnel Preparation for EHDI Service Providers

Presented by *Jackson Roush, Anne Marie Tharpe, Judith Gravel*

Time – 60 minutes

Room – Burgundy

Thinking Outside the Box: Creating Private-Public Partnerships

Presented by *Teresa H. Caraway, Tamara H. Elder, Jim Schmealzle*

Time – 60 minutes

11:40 am – 1:40 pm Lunch (On Your Own)
See Restaurants/
Map tab in your
program packet

AGENDA Cont'd

Topical Session 6
1:00 pm – 2:00 pm
Tuesday, February 26, 2008

Room – St. Charles B

Building Community Capacity for EHDI Services Statewide

Presented by *Kelly Daniel, Eric S. Cahill, Lou Ann Jones*
Time – 60 minutes

Room – Grand Ballroom A

Bone Conduction Hearing: A Natural Pathway to Hearing

Presented by *George Cire, Donna Sorkin*
Time – 60 minutes

Room – Grand Ballroom C

What's Your hIQ: Defining High Quality (hIQ) Intervention Services

Presented by *Paula Pittman, Arlene Stredler Brown*
Time – 60 minutes

Room – Grand Ballroom D

Supporting Informed Choice for Families of Deaf Children

Presented by *Gwen Carr*
Time – 30 minutes

The Infant Hearing Guide: A Tool for Early Interventionists

Presented by *Patti Martin, Nannette Nicholson*
Time – 30 minutes

Room – Toulouse A

CNMI and Our Efforts to Reduce Loss to Follow-up

Presented by *Angie Mister, Elizabeth Palacios*
Time – 30 minutes

“Like a Good Neighbor” - Integrate with Other State Databases to Help Improve Follow-up

Presented by *Michelle Garcia, Erin Estrada*
Time – 30 minutes

Room – Toulouse B

Sound START of KS: Across the Prairie

Presented by *Carol Busch, Kim M. Aeillo*
Time – 30 minutes

1-3-6 in Kansas: The Role of Sound START in Supporting Sound Beginnings

Presented by *Carol Busch, Kim M. Aeillo*
Time – 30 minutes

Room – Iberville

Understanding Sensory Orientations of Deaf and Hard of Hearing Children

Presented by *Benjamin J. Bahan, Beth Benedict*
Time – 60 minutes

Room – Bienville

Language Rights

Presented by *Susan Schaller*
Time – 60 minutes

Room – Bourbon

Lobbying for Beginners: You Really Can Make a Difference!

Presented by *Joni Alberg*
Time – 60 minutes

Room - Burgundy

Ensuring Quality Audiology Services - Roundtable Discussion

Presented by *Lisa Satterfield, Jennifer Sherwood, Hallie Morrow*
Time – 60 minutes

AGENDA Cont'd

Topical Session 7
2:15 pm – 2:45 pm
Tuesday, February 26, 2008

Room – St. Charles A

A Diamond in the Rough

Presented by *Lorie Lang, Kylie Sharp*
Time – 30 minutes

Room – St. Charles B

**Newborn Hearing Screening in England:
Implementing and Maintaining a Quality
Programme**

Presented by *Nick Waddell*
Time – 30 minutes

Room – Grand Ballroom A

**Identifying the Most Common
Causes of Hearing Loss**

Presented by *Brenda Sommer*
Time – 30 minutes

Room – Grand Ballroom C

**Tracking and Referral via Web
Reports and GIS Technology**

Presented by *Shihfen Tu*
Time – 30 minutes

Room – Grand Ballroom D

**“Think Different”: How to Simplify
an ELDI Program to Keep Updated
in a Fast Paced World**

Presented by *Michelle Garcia*
Time – 30 minutes

Room – Toulouse A

**Ways to Help Parents Feel Comfortable
with ASL and Deaf Culture**

Presented by *Barb Di Giovanni,
Lisa DeWindt-Sommer*
Time – 30 minutes

Room – Toulouse B

**EHLI Challenges and Strategies in
Addressing Privacy Regulations**

Presented by *Todd Houston, Diane Behl*
Time – 30 minutes

Room - Iberville

**Cytomegalovirus: Survey of
Physicians’ Knowledge and Practices**

Presented by *Danielle S. Ross*
Time – 30 minutes

Room – Bienville

**Caregiver Stress in Families of Young
Children with Hearing Loss**

Presented by *Jareen Meinzen-Derr*
Time – 30 minutes

Room – Bourbon

Successful Support of Families

Presented by *Joni Alberg*
Time – 30 minutes

Room – Burgundy

**The Double-Edged Sword of Early Hearing
Detection and Intervention**

Presented by *Karen Hopkins, Lynn Schardel,
Vivian Mikhail*
Time – 30 minutes

3:00 pm – 3:45 pm State Team Meeting
**See room assignments
in State Meeting tab**

4:00 pm – 4:45 pm Closing Plenary
Grand Ballroom

**Language Development in Deaf Children:
Foundations and Outcomes**

(Continuing Medical Education Provided)
Presented by *Marc Marschark*
Moderated by *Irene Forsman*

EXHIBITORS

American Academy of Audiology
Advanced Bionics
Alexander Graham Bell Association for the Deaf & Hard of Hearing
American Academy of Pediatrics
American Speech-Language-Hearing Association
BEGINNINGS for Parents of Children Who Are Deaf or Hard of Hearing, Inc.
Caption First, Inc.
Cardinal Health NeuroCare/Grason Stadler
Centers for Disease Control and Prevention
Cochlear Americas
Hands & Voices
HiTrack
Mimosa Acoustics
National Cued Speech Association
New Orleans Oral School
Oral Deaf Education
Oticon, Inc.
Otodynamics
OZ Systems
Phonak
School Health Corporation
Siemens Hearing Instruments
SonaMed Corporation
Vivosonic, Inc.

THANK YOU TO THE FOLLOWING EXHIBITORS FOR
SPONSORING LUNCH ON MONDAY.

Advanced Bionics
American Academy of Audiology
American Speech-Language-Hearing Association
Cardinal Health NeuroCare/Grason Stadler
HiTrack
Phonak
Oticon, Inc.
OZ Systems
Vivosonic, Inc.

Special thanks to Med-Acoustics, Inc. for sponsoring the brass band entertainment at Monday evening's Reception.

POSTER SESSION

Poster Session
12:15 pm – 1:00 pm
Monday, February 25, 2008

ASTOR GALLERY

1000 Hz Tympanometry for the Older End of the EHDl Spectrum

Presenters: *Wendy D. Hanks, Melanie Coll*

A New Frontier: Current EHDl Activities in Latin America

Presenters: *Barbara Gerner De Garcia, Claudia Gaffney, Susan Chacon*

Assessing Needs of Diverse Populations in the EHDl System

Presenters: *John Ribera, Claudia Gaffney, Susan Chacon*

Beyond UNHS: Outcomes from Comprehensive Periodic Screening

Presenters: *William Eiserman, Lenore Shisler, Jan Buhrmann, Terry Foust*

Data Compliance Scorecard

Presenters: *Christy Taylor, Sondi Aponte*

Deaf Adults' Perspectives on EI for Deaf and Hard of Hearing Children

Presenters: *Kayla Buswell, Mary June Moseley*

Don't Leave Home Without It: Assessment Guidelines

Presenters: *Mary Ann Lyon, Kylie Sharp*

Effects of Health Professionals' Advice on Parental Decision-Making

Presenter: *Lori A. Day*

Evidence-Based Medical Algorithm for Infants with SNHL

Presenters: *Mary Meier, Yaoli Li*

Families Resistant to Hearing Aid Use for Their Children

Presenter: *Jana L. Zeigerman*

Findings from an Evaluation of Loss to Follow-Up in Five State EHDl Programs

Presenters: *Lucia Rojas Smith, James Hersey, Christine Layton, Meera Viswanathan, Ina Wallace, Tabitha Hendershot, Lanting Dai*

Hearing Loss and "Very Early" EI: Emerging Language & Behavior at Two

Presenters: *Betty Vohr, Julie A. Jodoin-Krauzyk, Richard Tucker, Mary Jane Johnson, Deborah Topol, Marianne Ahlgren*

Integrating EHDl & Metabolic Screens: Break Down of Information Silos

Presenters: *Thalia Wood, John Cartwright, Lura Daussat*



POSTER SESSION Cont'd

Poster Session – Continued

GRAND GALLERY

Issues in Unilateral and Bilateral Minimal Hearing Loss - Part 1

Presenters: *Carol Knightly, Sarah McKay, Judith Gravel*

Issues in Unilateral and Bilateral Minimal Hearing Loss - Part 2

Presenters: *Judith Gravel, Estelle Goldsmith, Sarah McKay, Carol Knightly*

Issues in Unilateral and Bilateral Minimal Hearing Loss - Part 3

Presenters: *Sarah McKay, Carol Knightly, Judith Gravel*

Knowledge Needs on Cochlear Implantation

Presenter: *Donna L. Sorkin*

Lost to Follow-up: Proving a Small Change Can Make a Difference

Presenter: *Lori Mibus*

Multidisciplinary Care of Childhood Hearing Loss: CATIPIHLER

Presenter: *Eileen Rall*

New 2006 CDC EHDI Data: What Progress Has Been Made?

Presenter: *Marcus Gaffney*

One, Two, Three - Red Light! Data Management and Tracking... At a Glance

Presenter: *Sallie C. McCall*

Partnering with Families

Presenter: *Maryann C. Swann*

The New Jersey Pediatric Hearing Health Care Directory

Presenter: *Karyn A. Dynak*

The Process of Grief in Mexican Parents of Hearing Loss Children

Presenter: *Sandra Veronica Perez-Izquierdo*

TN-CHP: Web Model to Improve Follow-up of Hearing Screening

Presenters: *Carmen B. Lozzio, Jacque Cundall, Barbara Nicodemus, Michelle Liao*

Washington State EHDDI Summits: Creating Partnerships

Presenters: *Amber Roche, Karin Neidt*

What's So Special About Dads?

Presenters: *Cory MacIver, Holly F. Pedersen*



PRESENTER INDEX

Aiello, Kim M., MA
Topical 6

Alberg, Joni, PhD
Topical 1, 2, 6, 7

Al-Mondhiry, Rend, Esq.
Topical 5

Aponte, Sondi, AS
Poster

Bahan, Benjamin J., PhD
Topical 5, 6

Beams, Dinah, MA
Topical 2, 4, 5

Behl, Diane, MEd
Topical 7

Benedict, Beth, PhD
Plenary III,
Topical 2, 5, 6

Berry, Michael, BSE
Topical 3

Bhatia, Parul, MD
Topical 5

Biernath, Krista, MD
Topical 1

Block, Constance, BS MA
Topical 3

Bowman, Bob, MS
Topical 4, 5

Brown, Nicole, MSN, PHN, CPNP
Topical 1

Busch, Carol, MS
Topical 6

Buswell, Kayla, MS, CFY-SLP
Poster

Cahill, Eric S., MS CCC-A
Topical 3, 6

Caraway, Teresa H., PhD, CCC-SLP, Cert AVT
Topical 4, 5

Carr, Gwen
Topical 6

Cartwright, John
Poster

Chacon, Susan, MSW, LISW
Poster

Choo, Daniel, MD FAAP
Topical 3

Chung, Winnie, AuD
Topical 4

Cire, George, AuD
Topical 6

Cochenour, Laurie, MEd
Topical 2

Crace, JoDee
Plenary III

Croyle, Carol, MA
Topical 4

Daniel, Kelly, MS, CCC-A
Topical 6

Daussat, Lura, MPH
Topical 1

Day, Lori
Poster

DelRosario, Genevieve, MHS, PA-C
Topical 1

Delulio, Joe, BS
Topical 2

DesGeorges, Janet
Plenary III, Topical 3, 5

DeWindt-Sommer, Lisa
Topical 7

Di Giovanni, Barb
Topical 7

Diefendorf, Allan, PhD
Topical 2

Dowling, Cheri
Topical 3

Dynak, Karyn, BA
Poster

Earl, Polly, EdD
Topical 2

Eichwald, John, MA FAAA
Plenary III

Eiserman, William, PhD
Poster, Topical 2

Elder, Tamara H., MS CCC-SLP, Cert AVT
Topical 4, 5

Elliott, Susan, MA, NBCT
Plenary III

Ellis, Jill, MEd
Topical 2, 3

Estrada, Erin, BA
Topical 6

Fairbanks, Toni
Topical 1

Folsom, Richard, PhD
Topical 1

Forsman, Irene, RN, MS
Closing Plenary

Foust, Terry, Au.D
Poster, Topical 2

Gaffney, Claudia, DDS MPH
Poster

Gaffney, Marcus, MPH
Poster

Garcia, Michelle, M.A., CCC-A
Topical 6, 7

Germano, Jennie, MEd
Topical 2, 4

Gerner De Garcia, Barbara, EdD
Poster

Gilmore Eubanks, Christine, PhD
Topical 5

Goldsmith, Estelle
Poster

Gravel, Judith S., PhD
Poster, Topical 2, 5

Hakim, Penny
Topical 2

Hanks, Wendy D., PhD
Poster

Hanna, Doris, RN, CPNP, SCD
Topical 1

Hardin, Fran, MA
Topical 3

Hartnett, Mary
Topical 1

PRESENTER INDEX Cont'd

- Harward, Richard, MS**
Topical 4
- Hecht, Julia, MD FAAP**
Plenary III
- Hess, Mary Catherine, MA**
Topical 3
- Hinman, Alan, MD MPH**
Topical 1
- Hopkins, Elizabeth, BA**
Topical 3
- Hopkins, Karen**
Topical 7
- Hossler, Erica, BA**
Topical 4
- Hossler, Tami, MA**
Topical 4
- Houston, Todd, PhD, CCC-SLP, Cert AVT**
Topical 2, 7
- Howell, Catherine, MA**
Topical 3
- Hutsell, Gayla, MA CCC-A/SLP, Cert AVT**
Topical 2, 4, 5
- Jones, Lou Ann, MS CCC-A**
Topical 6
- Kaahanui, Amanda**
Topical 4
- Kaftan, Allison, BA**
Topical 2
- Keown, Wendy, RN**
Topical 3
- King, Michelle, MS, CCC-A**
Plenary III
- Knightly, Carol, AuD, CCC-A**
Poster
- Kolvitz, Marcia, PhD**
Topical 4
- Kovacs, Lisa**
Plenary III
- Lang, Harry,**
Opening Plenary
- Lang, Lorie J., MA, CCC-A**
Topical 7
- LeBlanc, Barbara, Ed Spec, MA CCC-SLP**
Topical 2
- Lee, Diana, MEd**
Topical 3
- Leigh, Irene W.,**
Opening Plenary
- Leitz, Curt**
Plenary III
- Li, Yaoli, MD, MS, MA, CCC-A**
Poster
- Lindow-Davies, Candace**
Topical 5
- Lozzio, Carmen, MD**
Poster
- Lyon, Mary Ann, MS, CCC-A**
Poster
- Marschark, Marc, PhD**
Closing Plenary
- Martin, Patti, PhD**
Topical 1, 2, 3, 6
- Mathers, Ruth, MS**
Plenary III, Topical 2
- McCall, Sallie**
Poster
- McCarthy, Melissa, MEd**
Topical 2
- McCaskill, Carolyn,**
Opening Plenary
- McKay, Sarah, MEd**
Poster
- McIver, Cory, BS**
Poster
- Meier, Mary, AuD**
Poster
- Meinzen-Derr, Jareen, PhD**
Topical 3, 7
- Mibus, Lori**
Poster
- Mikhail, Vivian, JD**
Topical 7
- Mister, Angie, AuD**
Topical 6
- Moeggenberg, Carissa, MA CCC-A**
Topical 1
- Moeller, Mary Pat, PhD**
Topical 5
- Moog Brooks, Betsy, MS-CED**
- Morris, Djenne**
Plenary III
- Morrow, Hallie, MD FAAP**
Topical 1, 2, 4, 6
- Munoz, Karen, EdD, CCC-A**
Topical 2
- Neidt, Karin, MPH**
Poster
- Nevins, Mary Ellen, EdD**
Topical 2
- Nicholson, Nannette, PhD**
Topical 1, 3, 4, 6
- Nittrouer, Susan, PhD**
Topical 2
- North, Jan, MEd, MACE, BSpecEd, CertTeach**
Topical 2
- Norton, Susan J., PhD, CCC-A**
Topical 1
- Oliva, Gina, PhD**
Topical 4
- Olson, Stephanie**
Plenary III, Topical 5
- Oyler, Anne, AuD, CCC-A**
Topical 5
- Palacios, Elizabeth, BS**
Topical 6
- Pedersen, Holly F., MS**
Poster
- Perez-Izquierdo, Sandra Veronica, MS**
Poster
- Pittman, Paula, PhD**
Topical 1, 6
- Potter, James, CAE**
Topical 5
- Powell, Meghan**
Topical 4
- Raimondo, Barbara, JD**
Opening Plenary, Topical 2, 4, 5
- Rall, Eileen, AuD, CCC-A**
Poster
- Randall, Kurt, Med, MS, CCC-A**
Topical 4

PRESENTER INDEX Cont'd

- Ribera, John, PhD, CCC-A, FAAA**
Poster
- Robbins, Nicole, AuD**
Topical 4
- Roche, Amber, MPH**
Poster
- Rojas Smith, Lucia, DrPH**
Poster
- Ross, Danielle S., PhD, MSc**
Topical 7
- Roush, Jackson, PhD**
Topical 5
- Russ, Shirley, MD MPH**
Topical 1
- Sass-Lehrer, Marilyn, PhD**
Topical 2, 4, 5
- Satterfield, Lisa, MS, CCC-A**
Topical 2, 4, 6
- Schaller, Susan, MS**
Topical 6
- Schardel, Lynn**
Topical 7
- Schmaelzle, Jim, MCD, CCC-A**
Topical 5
- Schmeltz, Les, AuD**
Topical 5
- Seaver, LEEANNE, MA**
Topical 2, 5
- Seeliger, Elizabeth L., MA CCC-A**
Topical 5
- Sexton, Johnnie, MS**
Topical 4
- Sharma, Anu, PhD**
Plenary II
- Sharp, Kylie, AS**
Plenary III, Poster,
Topical 4, 7
- Sherwood, Jennifer, MA**
Topical 2, 4, 6
- Sokolov, Yuri, PhD**
Topical 5
- Sommer, Brenda J., RN**
Topical 7
- Sorkin, Donna, MA**
Poster, Topical 6
- St. John, Rachel, MD FAAP**
Plenary III
- Storebeck, Claudine, PhD**
Topical 1
- Stredler Brown, Arlene, MA, CCC-SLP, CED**
Topical 5, 6
- Stremel, Kathleen M., MS**
Topical 4
- Stroud, Jan, AuD**
Topical 1, 3, 4
- Swann, Maryann, MS**
Poster
- Tashjian, Christene, MPA**
Topical 1
- Taylor, Christy**
Poster
- Taylor, Denise, MA CCC-SLP**
Topical 2
- Tharpe, Anne Marie, PhD**
Topical 2, 3, 5
- Thompson, Nanette, MA, CCC-AVT**
Topical 2
- Thomson, Vickie, PhD**
Topical 3
- Torghelle, Karen, MPH, BSN**
Topical 1
- Tu, Shihfen**
Topical 7
- Tucker, James,**
Opening Plenary
- Vanbiervliet, Alan, PhD**
Topical 4
- Vohr, Betty, MD FAAP**
Poster
- Waddell, Nick**
Topical 3, 7
- Wagner, Melissa A.**
Topical 3
- Wainscoat, Sarah, MEd**
Topical 4
- Watkins, Chris, MA**
Topical 5
- White, Karl, PhD**
Opening Plenary
- Wiley, Susan, MD FAAP**
Plenary II, Topical 1, 3
- Wilson, Kathryn, MA, CCC-SLP, Cert AVT**
Topical 1
- Winston, Randi, AuD**
Topical 1
- Wood, Thalia, MPH**
Poster
- Wright, Cami**
Plenary III
- Young, Alys, PhD, MSc, MA, CQSW**
Topical 1
- Ziegberman, Jana, AuD**
Poster
- Zonno, Kristi, MS**
Topical 4

NOTES

NOTES

NOTES

NOTES

NOTES

NOTES

NOTES



NOTES

NOTES

NOTES

NOTES

NOTES

NOTES

NOTES

NOTES

NOTES

NOTES

NOTES

NOTES

NOTES

**N
O
T
E
S**

NOTES

NOTES

HOTEL LAYOUT

FIRST FLOOR / LOBBY

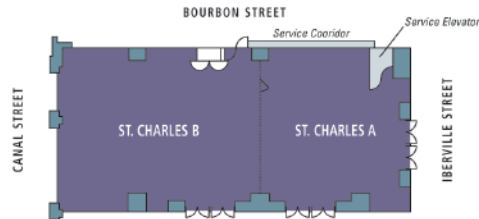

SECOND FLOOR

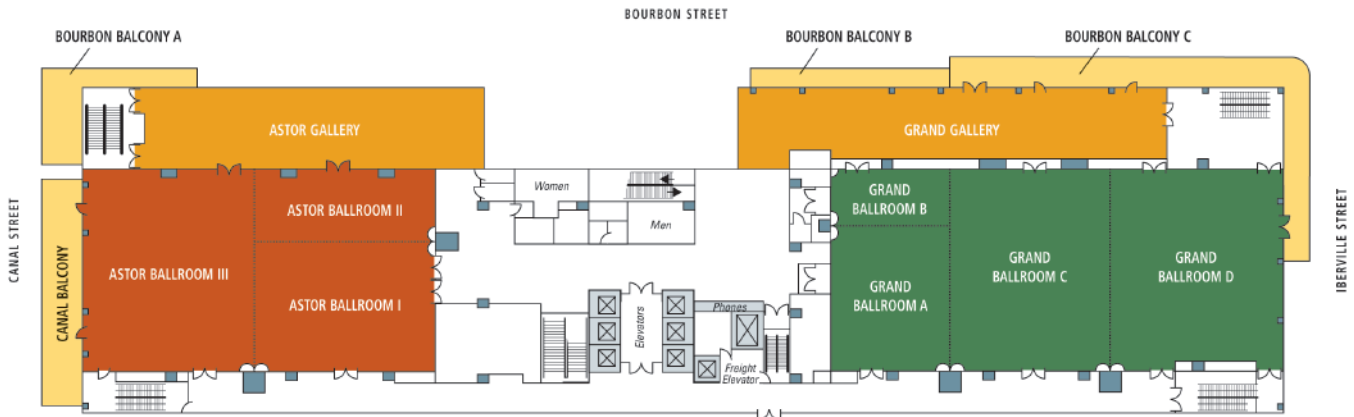

SECOND FLOOR MEZZANINE

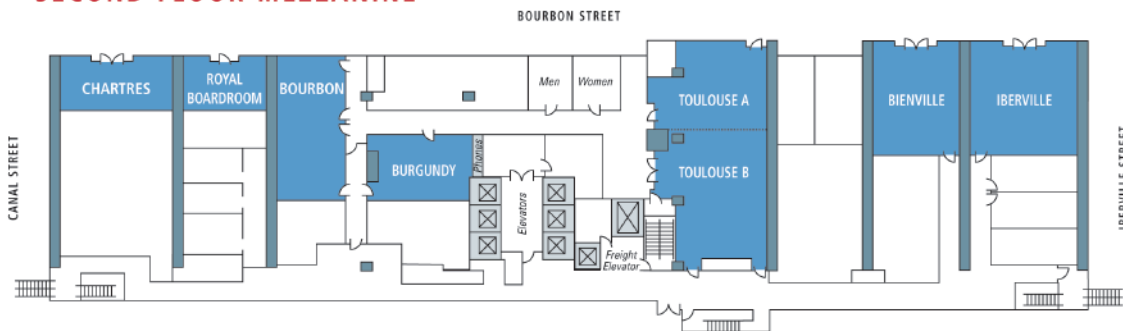

2008
EHDI

NATIONAL EARLY HEARING
DETECTION AND INTERVENTION
CONFERENCE

U.S. Department of Health and Human Services

Health Resources and Services Administration

Centers for Disease Control and Prevention

National Center for Hearing Assessment and Management

American Academy of Pediatrics